



HydroTap G5 BCHA20 4-in-1 Classic Plus tap with Arc Mixer Chrome

Boiling Chilled

 **Finish:** Chrome

Product code: H55821Z00AU

Capacity: Commercial

Zip HydroTap Classic Plus 4 in 1 Boiling, Chilled, Filtered water plus Hot and Cold washing up water from two separate taps. The system features a single under bench command centre including full colour interactive touch screen display with pin code protection and customisable settings including 2 boiling water safety modes, 3 energy saving modes including ON/OFF timers and sensor activated 'sleep when it's dark', 'Quiet' mode with automated intelligent fan speed adjustment, antimicrobial protection impregnated into key water paths for enhanced hygiene, 100% water efficient air cooled technology, and 0.2 micron water filtration.

Specifications

Product name	HydroTap G5 BCHA20 4-in-1 Classic Plus tap with Arc Mixer Chrome
Product code	H55821Z00AU
Filtered water type	BCHA
Product approvals	WaterMark, RCM, ARC
WELS rating	5 Star, 6 litres
Warranty	5 years (appliance warranty 36 months plus additional 24 months tank warranty)
Chilling Technology	Air cooled technology making it 100% water efficient

Capacity, weight & dimensions

Number of people	1-20
Boiling cups per hour	100
Chilled cups per hour	75

Plumbing

Water supply requirements	Cold
Water connection	1/2" BSP (G1/2)
Water valves	Integrated 500kPa Pressure limiting valve and Dual Check Valve
Water pressure	Min 300kPa - Max 700kPa

Electrical

Power rating	1.9kW 220-240V 50Hz
Power supply	1 × 10 Amp socket outlet

Tap design

Tap	Zip HydroTap CLASSIC PLUS Tap (Chrome)
HydroTap style	Classic Plus
Mixer tap style	Arc
Finish	Chrome

Command centre

Dimensions

W395mm x D487mm x H333mm

Installation

Installation requirements

1. Installation and connection of your Zip HydroTap must be carried out by a qualified person, observing national and local regulations.
2. You will require suitable mains electrical and drinking water connections, plus waste water drainage. The HydroTap must be installed to within the limits of the hose and cable lengths supplied.
3. **Discrete cabinetry cut outs are required for airflow. 40mm minimum clearance on cupboard base overhang required otherwise alternative installation options are available.**
4. Installation on most bench tops is straightforward however some stone bench tops may require a specialised cutting service.
5. Installation by Zip Professional Service can be arranged with a phone call or through www.zipwater.com/book-service-visit

Files

Installation Layout 3D (DWG)

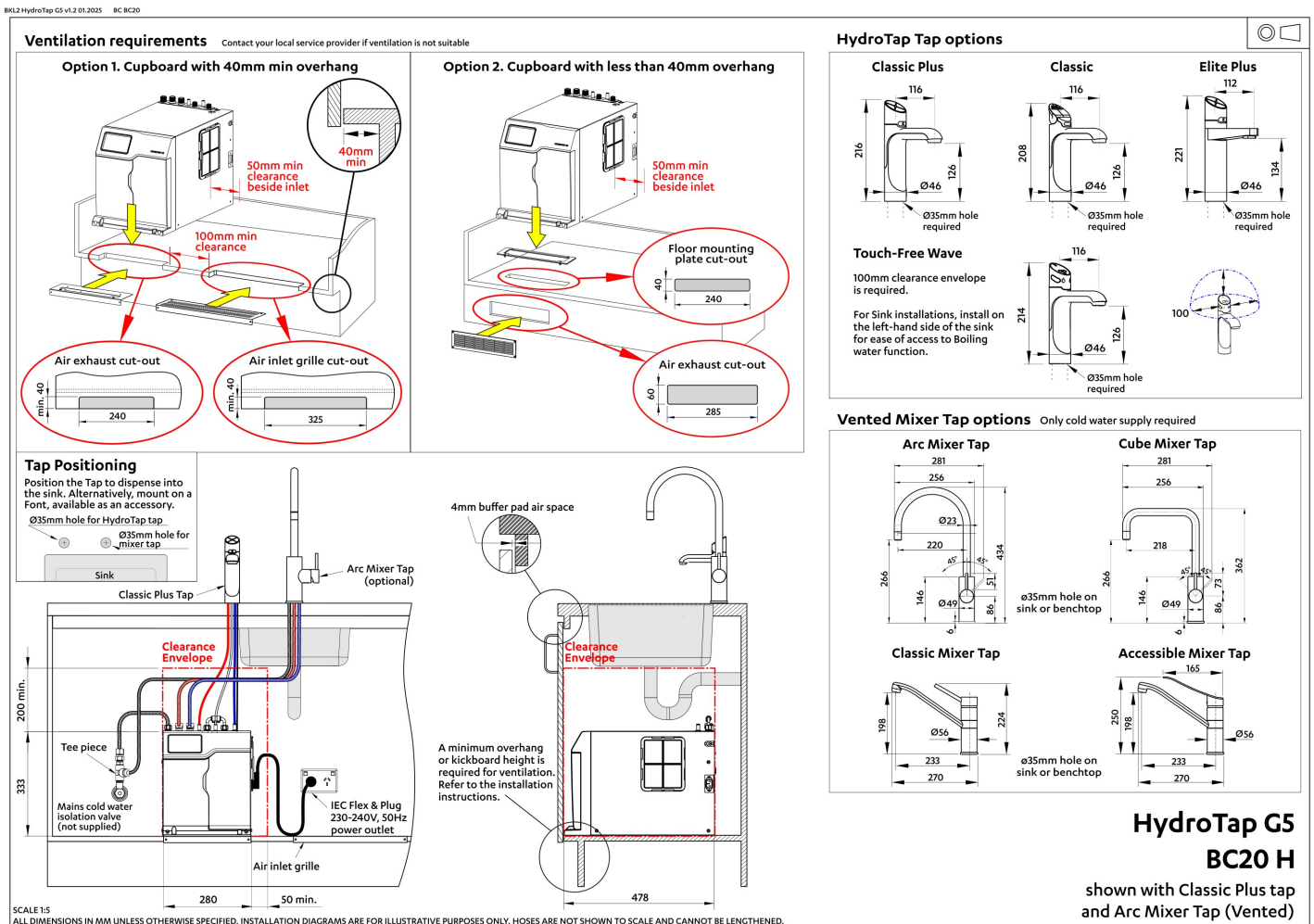

Installation Layout (PDF)

BIM files

LCF

↓ ArchiCAD Swift
Globals Library
(LCF)

LCF

↓ ArchiCAD Zip Water
Library (LCF)

RFA

↓ Revit Project File
(RFA)

RVT

↓ Revit Virtual
Showroom (RVT)

↓ Download all

Certifications



OHS
ISO 45001



Quality
ISO 9001



PDF

↓ ARC (PDF)

PDF

↓ Environment ISO
(PDF)

PDF

↓ Environmental
Product Declaration
Brochure (PDF)

PDF

↓ Filter performance
(PDF)

PDF

↓ Health & Safety
(PDF)

PDF

↓ HydroTap Clean
SDS (PDF)

PDF

↓ Quality ISO (PDF)

Manuals & brochures



 Brochure (PDF)



 Instruction manual (PDF)





 Quick guide (PDF)



 Tap operation label (PDF)



 User manual (PDF)

 Download all